

How do I create my RPR account?

Visit www.narrpr.com.

1 Click *Create a New Account*.

Enter your last name and email address or NAR Member ID, select *Next*.

Note: An activation email will be sent to you to complete your account set up. You have 3 hours to click "Activate my Account" before you need to redo the setup process.

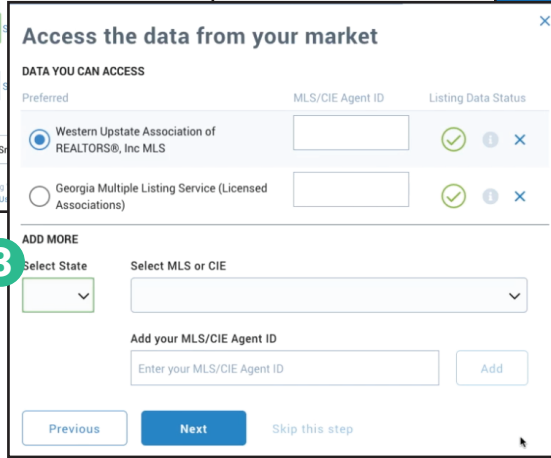
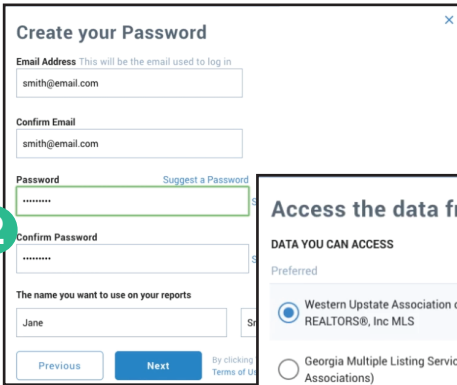
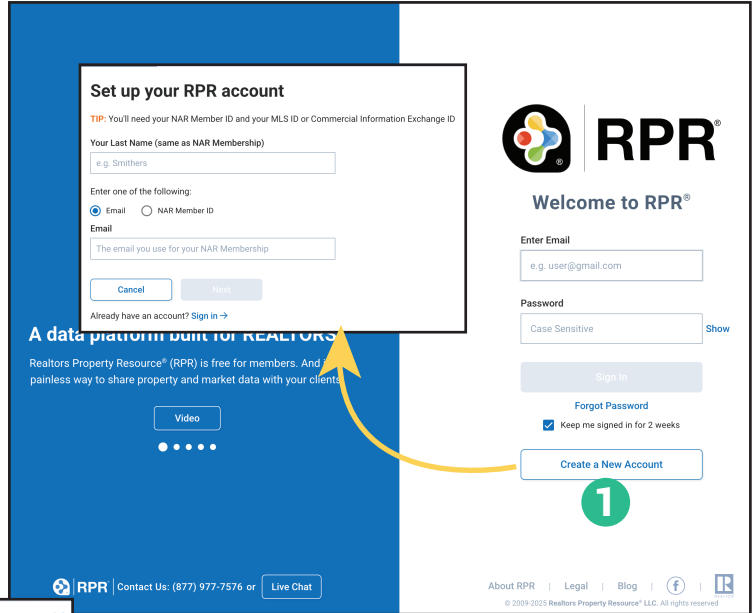

2 Create your Password.

3 Link your MLS or CIE information.

Note: Your information may be auto-populated from your NRDS account. If you belong to more than one MLS or CIE, link memberships here. You can access this information in your profile.

How do I access RPR Mobile™?

Download RPR from the App Store or Google Play for your phone.

4 Use your RPR login and password to access your account.

5 Tap Search to toggle between Commercial and Residential.

Access Residential and Commercial properties and reports... anywhere, anytime.

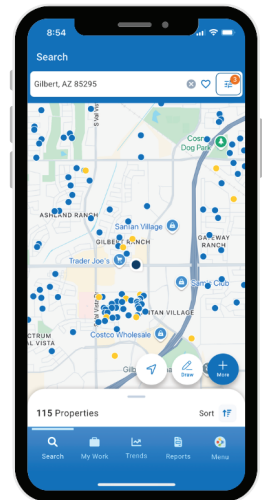
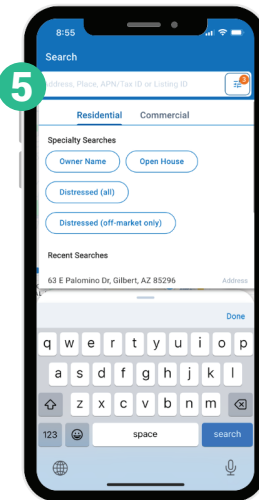
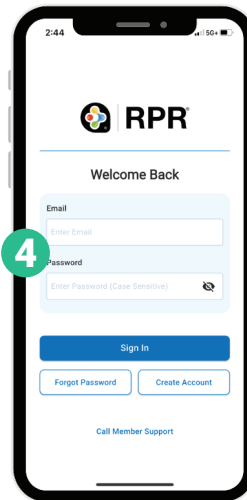

How do I create my RPR account?

● Visit www.narrpr.com.

1 Click *Create a New Account*.

● Enter your last name and email address or NAR Member ID, select *Next*.

Note: An activation email will be sent to you to complete your account set up. You have 3 hours to click "Activate my Account" before you need to redo the setup process.

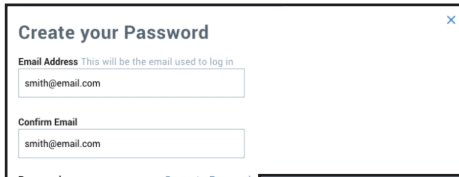
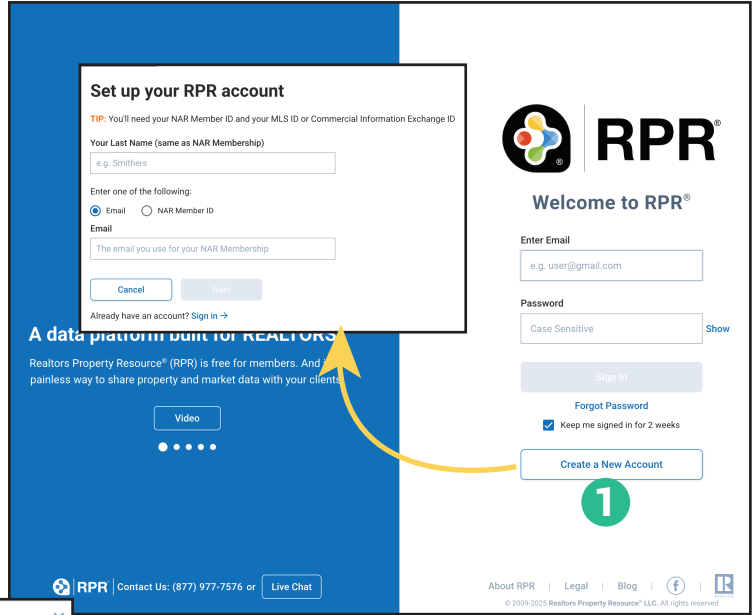

2

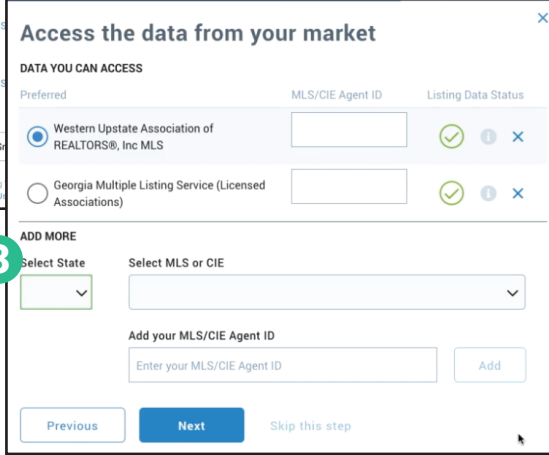

3

2 Create your Password.

3 Link your MLS or CIE information.

Note: Your information may be auto-populated from your NRDS account. If you belong to more than one MLS or CIE, link memberships here. You can access this information in your profile.

How do I access RPR Mobile™?

● Download RPR from the App Store or Google Play for your phone.

4 Use your RPR login and password to access your account.

5 Tap Search to toggle between Commercial and Residential.

● Access Residential and Commercial properties and reports... anywhere, anytime.

